

LAND & HOUSE OF GITA DAS & OTHERS
(VACANT LAND)

PLACED IN THE BUILDING COMMITTEE MEETING
HELD ON 06.12.2020 & RECOMMENDED

2 STORED BUILDING

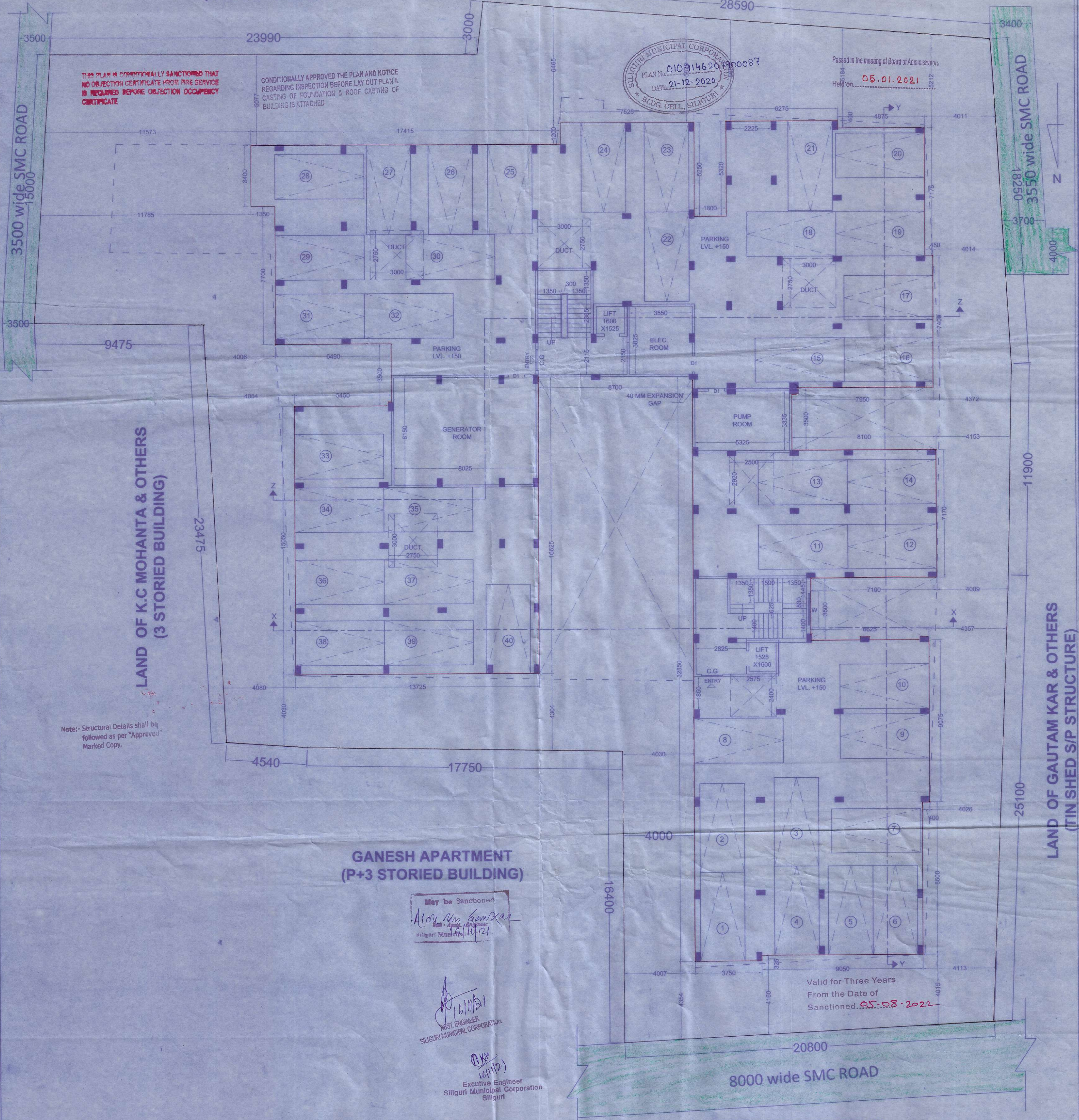

THIS PLAN IS CONDITIONALLY SANCTIONED THAT NO OBJECTION CERTIFICATE FROM FIRE SERVICE IS REQUIRED BEFORE OCCUPANCY CERTIFICATE

CONDITIONALLY APPROVED THE PLAN AND NOTICE REGARDING INSPECTION BEFORE LAY OUT PLAN & CASTING OF FOUNDATION & ROOF CASTING OF BUILDING IS ATTACHED



Passed in the meeting of Board of Administrators
Held on 05.01.2021

LAND OF K.C. MOHANTA & OTHERS
(3 STORED BUILDING)

LAND OF GAUTAM KAR & OTHERS
(TIN SHED S/P STRUCTURE)

GANESH APARTMENT
(P+3 STORED BUILDING)

May be Sanctioned
Alok Kumar Sanjay
Siliguri Municipal Corporation

WEST ENGINEER
SILIGURI MUNICIPAL CORPORATION
Executive Engineer
Siliguri Municipal Corporation
Siliguri

Valid for Three Years
From the Date of
Sanctioned 05.08.2021

GROUND (PARKING) FLOOR PLAN
SCALE: 1:100

CERTIFICATE OF STRUCTURAL STABILITY
I do hereby certify that the foundation and superstructure of the building proposed for construction on plot R.S.533, L.R. 83 Street I.T.I. ROAD Ward No. 41 under the jurisdiction of SILIGURI Municipality / Notified Area Authority / Industrial Township Authority have been personally inspected and so designed by me/ Us will make such foundation and super structure safe in all respect including the consideration of bearing capacity and settlement of soil and other conditions, if any, conforming to all stipulations of all relevant IS Code of practice and National Building code.

Signature of Structural Engineer
(Name, Address and empanclement No.)

Signature of Geo-technical Engineer
(Name, Address and Empanclement No.)

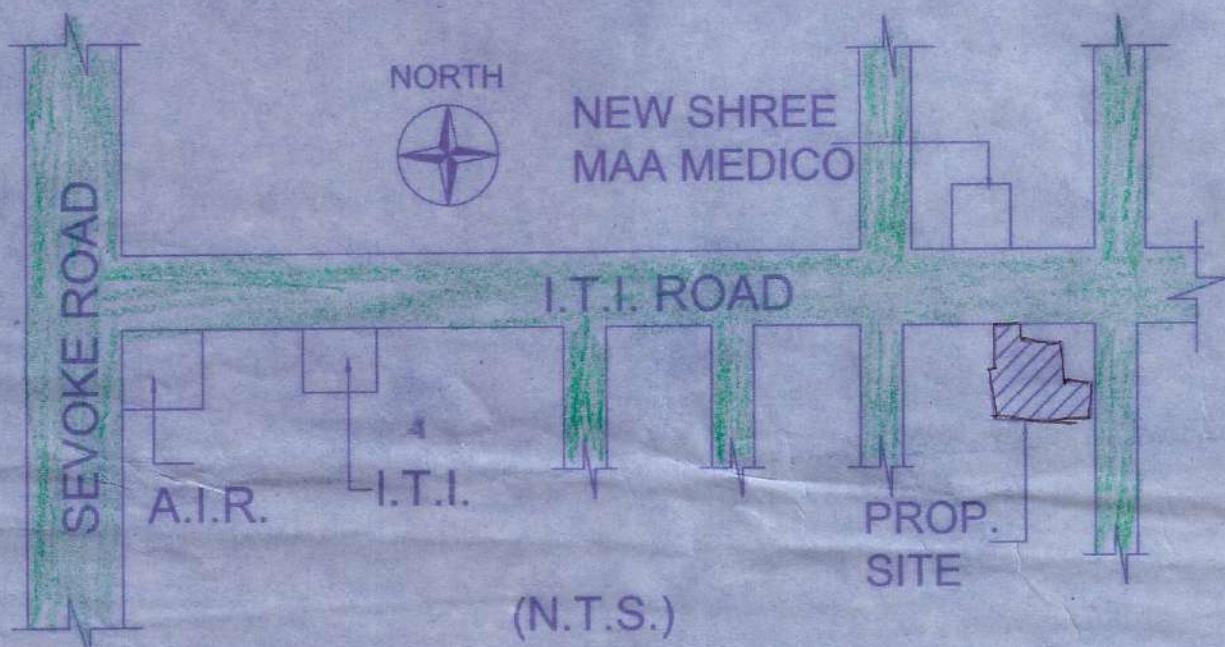

SPECIFICATIONS

- SOLING 75 THICK WITH FIRST CLASS BRICK
- R.C.C. 1:1.5:3 CEMENT CONCRETE
- P.C.C. 1:3:6 CEMENT CONCRETE
- D.P.C. 12:4 CEMENT CONCRETE
- STEEL Fe-550 GRADE
- MARBLE FLOORING IN ALL ROOMS
- MARBLE IN TOILET AND KITCHEN
- BRICK WALL 125 THICK AND 250 THICK WITH 1:4 MORTAR
- FRAME SIZE FOR DOORS/WINDOWS 100 X 75 mm
- PLASTIC PAINTS IN INTERIORS
- CEMENT PAINTS IN EXTERIORS
- SYNTHETIC EMAMEL IN DOOR/WINDOWS
- DIMENSIONS ARE IN MM
- APPROVED L.U.C.C. NO. DATE
- APPROVED SITE PLAN NO.
- GRADE OF CONCRETE - M20

SCHEDULE OF LAND

MOUZA	= DABGRAM
PARGANA	= BAIKUNTHAPUR
J.L. NO.	= 2
KHATIAN	= (R.S.) 180
SHEET	= (R.S.) 8/L.R. 42
PLOT	= (R.S.) 533
	(L.R.) 83
P.S.	= BHAKTINAGAR
DISTRICT	= JALPAIGURI
WARD NO.	= 41 (S.M.C.)

AREA STATEMENT

LAND AREA (AS PER DEED)	= 2261.71 SQ.M
LAND AREA (AS PER SITE)	= 2261.55 SQ.M
PERM. GROUND COVERAGE	= 50 % OR 1130.82 SQ.M
PROP. GROUND COVERAGE	= 45.93 % OR 1038.73 SQ.M
AREA LEFT AS OPEN SPACE	= 1222.52 SQ.M
GROUND (PARKING) FLOOR AREA	= 1038.73 SQ.M
1ST, 2ND, 3RD, 4TH & 5TH FLOOR AREA	= 1038.73 SQ.M
TOTAL FLOOR AREA	= 1038.73 SQ.M
NO. OF TENEMENTS	= 2:00
PERM. F.A.R.	= 1:90
LIFT STAIRCASE & PASSEGE AREA	= 154.82 SQ.M. (each x 8)
CAR PARKING REQUIRED	= 40 NOS.
CAR PARKING PROVIDED	= 48 NOS.
PERMISSIBLE HEIGHT OF THE BUILDING	= 28.00 M.
PROPOSED HEIGHT OF THE BUILDING	= 16.450 M
USE OF THE BUILDING	= RESIDENTIAL
TREE COVERED AREA REQUIRED = 352.80 SQ.M (15.59 %)	
TREE COVERED AREA PROVIDED = 352.60 SQ.M	

PROJECT TITLE
PROPOSED GROUND(PARKING) + FIVE STD. RESIDENTIAL BUILDING OF (1) SRI AMAN AGARWAL, PARTNER OF N.B. DEVELOPERS, (2) SRI MAHESH KR. AGARWAL, (3) SMT. BADAMI DEVI AGARWAL AND (4) RAHUL AGARWAL, AT I.T.I. ROAD, JOYTNAGAR, SILIGURI, P.S. BHAKTINAGAR, DIST. JALPAIGURI, WARD NO. 41. (S.M.C.)

I do hereby declare that the building proposed for construction shall be supervised by the L.B.A./L.B.S. signing the Building Plan Application or in his/her absence by any other L.B.A./L.B.S. of the appropriate category and as approved by the authority.

CERTIFICATE OF BUILDING PLAN
I/ We do hereby certify that plans, elevations and sections and other structural details of the proposed building on Plot No. R.S.533, L.R. 83 Ward No. 41 under the jurisdiction of S.M.C. Municipality / Notified Area Authority/ Industrial Township Authority have been prepared in conformity with all relevant provisions under the West Bengal Municipal (Building) Rules, 2007. This also to certify that all relevant 'No objection' Certificates from the respective Authorities such as Fire and Emergency Services Department, Airport Authority, Pollution Control Board, Telecommunication Department etc. as applicable in this regard, are also enclosed with the application for seeking approval of the plan to construct/reconstruct/addition to / alteration of the building on the said plot.

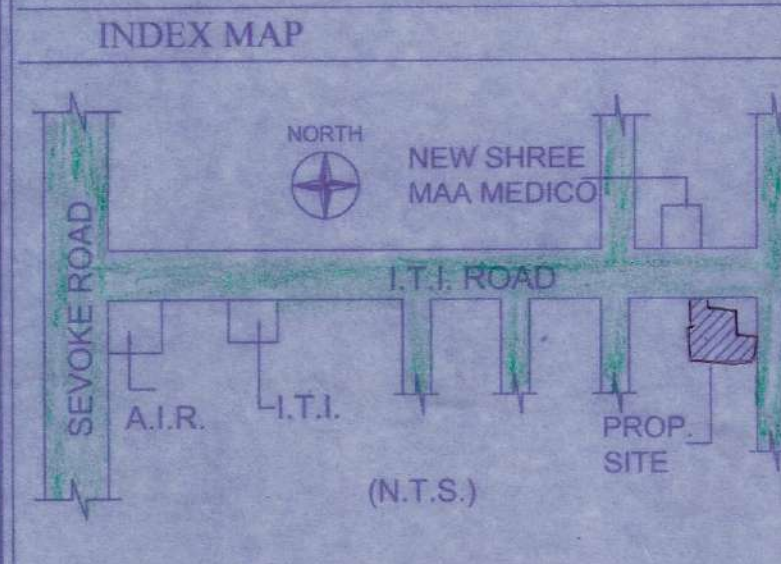

SCHEDULE OF OPENINGS

D	1050 X 2100
D1	900 X 2100
D2	750 X 2100
W	1800 X 1350
W1	1500 X 1350
W2	1200 X 1350
V	600 X 750
C.G.	1200 X 2100

DETAILS OF TENEMENTS AREA

FLAT - 01	= 109.77 SQ.M (EACH X 5)
FLAT - 02	= 89.42 SQ.M (EACH X 5)
FLAT - 03	= 76.25 SQ.M (EACH X 5)
FLAT - 04	= 89.30 SQ.M (EACH X 5)
FLAT - 05	= 83.91 SQ.M (EACH X 5)
FLAT - 06	= 88.89 SQ.M (EACH X 5)
FLAT - 07	= 75.07 SQ.M (EACH X 5)
FLAT - 08	= 85.16 SQ.M (EACH X 5)
FLAT - 09	= 99.36 SQ.M (EACH X 5)
FLAT - 10	= 94.59 SQ.M (EACH X 5)

Signature of Owner
Manoj Kumar
B.Arch
Regd. No. CA/95/18822
NB DEVELOPERS
Partner
SIGNATURE OF OWNER

Signature of Licensed Building Surveyor/ Architect (Name, Address and Empanclement No.)
Bhadra Architects & Engineers
457 BIDHAN ROAD, SILIGURI
DATE: 30-07-2021
SHEET NO. 1/4